



**JOINT MEETING OF THE
SOUTHERN & CARIBBEAN DIVISIONS
OF THE
AMERICAN PHYTOPATHOLOGICAL SOCIETY
IN CONJUNCTION WITH THE
THE EMERGING VIRUSES IN CUCURBITS WORKING
GROUP AND THE NORTH CENTRAL (NCAC14) AND
SOUTHERN (SAC11) ADVISORY COMMITTEES**

PROGRAM

**MARCH 9 – 13, 2025
IN-PERSON MEETING**

2024 – 2025 SD-APS Officers

President

Gary Vallad

University of Florida
Gulf Coast Research and Education Center
14625 CR 672
Wimauma, FL 33598
Email: gvallad@ufl.edu

President-Elect

Bhabesh Dutta

University of Georgia
Tifton, CAES Campus
2630 Rainwater Road
Tifton, GA 31793
Email: bhabesh@uga.edu

Vice President

Rebecca A. Melanson

Mississippi State University
Central MS Research and Extension Center
1320 Seven Springs Road
Raymond, MS 39154
Email: rebecca.melanson@msstate.edu

Past President

Daniel Anco

Clemson University
Edisto Research and Education Center
64 Research Road
Blackville, SC 29817
Email: danco@clemson.edu

Divisional Forum Rep - Southern

Terry Spurlock

University of Arkansas System Division of
Agriculture
Lonoke Extension and Research Center
2001 Highway 70 E
Lonoke, AR 72086
Email: tspurlock@uada.edu

Graduate Student Representatives

Elias Zuchelli

West TN Research & Educ Ctr.
605 Airways Blvd.
Jackson, TN 38301
Email: ezuchell@tennessee.edu

Roshni Panwala

University of Florida
Gulf Coast Research and Education Center
14625 CR 672
Wimauma, FL 33598
Email: r.panwala@ufl.edu

2025-2026 SD-APS Incoming Officer

Vice President (*Election is in process*)

Secretary-Treasurer

Katia Viana Xavier

University of Florida
Everglades Research and Education Center
3200 East Canal Street
Belle Glade, FL 33430
Email: kvianaxavier@ufl.edu

2024 – 2025 CD-APS Officers

President

Cecilia Hernández Zepeda

Centro de Investigación Científica de
Yucatán, A.C.
Calle 43 No. 130 x 32 y 34
Chuburná de Hidalgo; CP 97205
Mérida, Yucatán, México
Email: cecilia.hernandez@cicy.mx

Vice President

Amit Levy

University of Florida
Citrus Research and Education Center
700 Experiment Station Road
Lake Alfred, FL 33850
Email: amitlevy@ufl.edu

Past President

Martha C. Giraldo Zapata

Dept. of Agro-Environmental Sciences
College of Agricultural Sciences
University of Puerto Rico-Mayagüez
Campus
Mayagüez, PR 00681
Email: martha.giraldo@upr.edu

Secretary-Treasurer

Megan M. Dewdney

University of Florida
Citrus Research and Education Center
700 Experiment Station Road
Lake Alfred, FL 33850
Email: mmdewdney@ufl.edu

Divisional Forum Representative

Caribbean

Cecilia Monclova-Santana
Washington, DC
Email: Cecilia.monclova@gmail.com

2025-2026 CD-APS Incoming officers

President

Amit Levy

University of Florida
Citrus Research and Education Center
700 Experiment Station Road
Lake Alfred, FL 33850
Email: amitlevy@ufl.edu

Vice President

Rajagopalbabu Srinivasan

Department of Entomology
University of Georgia
1109 Experiment Street
Griffin, GA 30223
Email: babusri@uga.edu

Divisional Forum Representative

Kathleen Martin

Entomology & Plant Pathology
Auburn University
Auburn, AL 36849
Email: kmm0173@auburn.edu

Secretary-Treasurer

Megan M. Dewdney

University of Florida
Citrus Research and Education Center
700 Experiment Station Road
Lake Alfred, FL 33850
Email: mmdewdney@ufl.edu

2025 JOINT SOUTHERN & CARIBBEAN DIVISIONS of APS MEETING - SCHEDULE

TIME (Eastern)		SUNDAY MAR. 9, 2025	MONDAY MAR. 10, 2025	TUESDAY MAR. 11, 2025	WEDNESDAY MAR. 12, 2025	THURSDAY MAR. 13, 2025	
MORNING	8:00 AM		WELCOME		SYMPOSIUM: Breaching Cultural and Global Barriers to Elevate Plant Health <i>Century Ballroom A</i>	FIELD TOURS: Visit to PSREU and Paynes Prairie NCAC14/SAC11 and AULF (Members only) - Hickory Emerging Viruses of Cucurbits Working Group - Azalea	
	8:15 AM						
	8:30 AM						
	8:45 AM						
	9:00 AM		SOUTHERN GRADUATE RESEARCH COMPETITION SESSION I (7 PRESENTATIONS) <i>Century Ballroom A</i>	ORAL TECHNICAL SESSION I (7 PRESENTATIONS) <i>Century Ballroom A</i>			
	9:15 AM						
	9:30 AM						
	9:45 AM						
	10:00 AM		BREAK: Network				
	10:15 AM						
	10:30 AM		SOUTHERN GRADUATE RESEARCH COMPETITION SESSION II (7 PRESENTATIONS) <i>Century Ballroom A</i>	ORAL TECHNICAL SESSION II (7 PRESENTATIONS) <i>Century Ballroom A</i>			SYMPOSIUM: INDUSTRY SPONSORS <i>Century Ballroom A</i>
	10:45 AM						
	11:00 AM						
	11:15 AM						
11:30 AM							
11:45 AM							
AFTERNOON	12:00 PM	CD-APS & SD-APS EXECUTIVE MEETINGS <i>Magnolia & Cedar</i>	LUNCH BREAK AND POSTER VIEWING	WORKSHOP: CAREERS 101 - Strategic Conversations <i>Century Ballroom A</i>	LUNCH BREAK AND POSTER VIEWING <i>Century Ballroom B & C</i>	LUNCH BREAK AND BUSINESS MEETING <i>Century Ballroom A</i> (REMOVE POSTERS BY 1PM)	
	12:15 PM						
	12:30 PM						
	12:45 PM						
	1:00 PM						
	1:15 PM						
	1:30 PM						
	1:45 PM						
	2:00 PM		SOUTHERN/CARRIBEAN GRADUATE RESEARCH COMPETITION SESSION III (6 PRESENTATIONS) <i>Century Ballroom A</i>	ORAL TECHNICAL SESSION III (6 PRESENTATIONS) <i>Century Ballroom A</i>	ORAL TECHNICAL SESSION V (6 PRESENTATIONS) <i>Century Ballroom A</i>		
	2:15 PM						
	2:30 PM						
	2:45 PM						
	3:00 PM		BREAK: Network				
	3:15 PM		CARRIBEAN GRADUATE RESEARCH COMPETITION SESSION IV (5 PRESENTATIONS) <i>Century Ballroom A</i>	ORAL TECHNICAL SESSION IV (5 PRESENTATIONS) <i>Century Ballroom A</i>	ORAL TECHNICAL SESSION VI (6 PRESENTATIONS) <i>Century Ballroom A</i>		
3:30 PM							
3:45 PM							
4:00 PM							
4:15 PM							
4:30 PM							
4:45 PM							
EVENING	5:00 PM	REGISTRATION & POSTER SET-UP <i>Century Ballrooms B & C</i>	BREAK: Poster Viewing <i>Century Ballroom B & C</i>		BREAK		
	5:15 PM						
	5:30 PM						
	5:45 PM						
	6:00 PM		NETWORKING EVENT: WELCOME RECEPTION AND POSTER VIEWING (6 - 8 PM) <i>Century Ballroom B & C</i>	NETWORKING EVENT: GRAD STUDENT/POST-DOC BUSINESS MEETING & NETWORKING EVENT OFFSITE: <i>Fifield Hall</i>	NETWORKING EVENT: AWARDS BANQUET (6 - 9 PM) <i>Century Ballroom A</i>		
	6:15 PM						
	6:30 PM						
	6:45 PM						
	7:00 PM						
7:15 PM							
7:30 PM							

Hilton
 University of Florida
 Conference Center

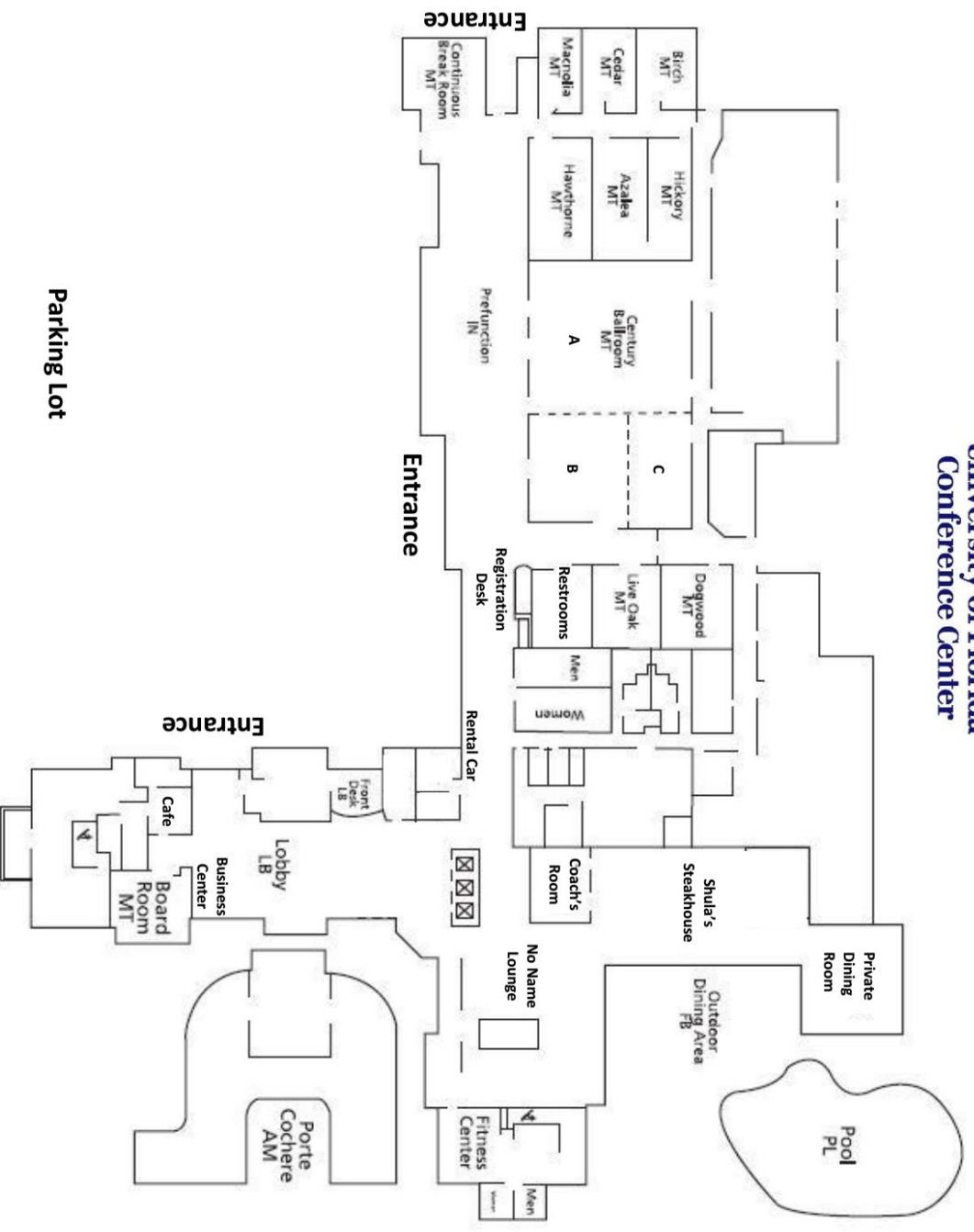

Parking Lot

Parking Lot



AMERICAN PHYTOPATHOLOGICAL SOCIETY **Joint SOUTHERN & CARIBBEAN DIVISIONS MEETING PROGRAM**

The 102nd annual meeting of the American Phytopathological Society, Southern Division is meeting jointly with the Caribbean Division at the Hilton University of Florida Conference Center Gainesville, FL. The meeting is in-person. Unless otherwise specified, all program events will take place at the Hilton University of Florida Conference Center. ***The main program will take place in the Century Ballroom A***; any location changes for specific events are noted in the program event listing. Hors d'oeuvres will be available at the Welcome Reception on Monday evening. In lieu of a cash bar during the Welcome Reception, participants are welcome to use the bar at the No Name Lounge. Additional details regarding transportation and meals are included in the program at the listing for each event. ***All times listed in this program are in Eastern Time (ET).***

Photos may be taken during the meeting by SD-APS Executive Committee members. As a meeting registrant and attendee, you agree to allow the SD-APS to use your photo in APS publications and on the SD-APS and CD-APS websites and social media pages. As a courtesy to presenters, please ***do not take photos or screenshots*** of posters or presentation slides without presenter approval.

Join us on Facebook and X, formerly Twitter! - “Like” and follow the **APS Southern Division** and the **APS Southern Division - Graduate Students** pages on Facebook and follow the **APS SouthernDivision** (@sd_aps) on X! Document your experiences throughout the meeting and post your photos using **#SDAPS2025**.

Sunday, March 9, 2025

- | | |
|----------------|---|
| 3:00 - 4:30 PM | SD-APS Executive Committee Meeting
<i>Location: Magnolia</i> |
| 3:00 - 4:30 PM | CD-APS Executive Committee Meeting
<i>Location: Cedar</i> |
| 5:00 - 6:30 PM | Registration and Poster Set-Up
<i>Location: Century Ballrooms B & C</i> |

Monday, March 10, 2025

- 8:00 – 8:15 AM **Welcome**
Gary Vallad, SD-APS President, Professor, Plant Pathology, University of Florida, Gulf Coast Research and Education Center, Wimauma, FL
Cecilia Hernández Zepeda, CD-APS President, The Yucatan Center for Scientific Research, Mexico.
- Graduate Student Research Competition (Session I)**, Moderators: Roshni Panwala and Elias Zuchelli, SD-APS Graduate Student Representatives
- 8:15 – 8:30 AM Investigation into the impact of crop residue on Fusarium head blight of hemp. **Henry Smith**, Annika Church, Nicole Gauthier; University of Kentucky, Lexington, KY.
- 8:30 - 8:45 AM Survivability of *Pantoea stewartii* subspecies *indologenes* and its risk to onions in Poaceae-Allium cropping systems. **Santosh Koirala**, Anuj Lamichhane, Bhabesh Dutta; University of Georgia, Tifton, GA.
- 8:45 – 9:00 AM Tracking aerosolization and long-distance dispersal of *Xanthomonas euvesicatoria* pv. *perforans* during mock pesticide applications. **Renzo Ramirez**¹, Garrett Giles¹, Walt Mahaffee², Jeffrey B. Jones¹, and Gary Vallad³; ¹University of Florida, Gainesville, FL, ²USDA-ARS HCDPMRU, ³Gulf Coast Research and Education Center, University of Florida, Wimauma, FL.
- 9:00 – 9:15 AM Fungicide sensitivity and virulence of *Exserohilum turcicum* isolates from maize in Florida. **Vitor S. Moura**¹, Alba Myers¹, Marcio F. R. Resende², and Katia V. Xavier¹; ¹Everglades Research and Education Center, University of Florida, Belle Glade, FL, ²University of Florida, Gainesville, FL.
- 9:15 – 9:30 AM Mixtures of biorational fungicides with low dose DMI fungicides to manage brown rot of peach. **Johanna Wesche** and Guido Schnabel; Clemson University, Clemson, SC.
- 9:30 – 9:45 AM *Xylella fastidiosa*: its presence, vectors, and subspecies on diverse cropping systems. **Alexandra Ratay** and Elizabeth Cieniewicz; Clemson University, Clemson, SC.
- 9:45 – 10:00 AM First report of *Colletotrichum theobromicola* causing celery leaf curl in the United States. **Fernanda Rodrigues Silva**^{1,2}, Mario L. V. de Resende², and Katia V. Xavier¹; ¹Everglades Research and Education Center, University of Florida, Belle Glade, FL, ²Universidade Federal de Lavras, Lavras, Brazil.
- 10:00 – 10:15 AM BREAK: Networking – Century Ballrooms B & C**

Graduate Student Research Competition (Session II) Moderators: Vitor Moura and Navjot Kaur,
SD-APS Graduate Students

- 10:15 – 10:30 AM Effect of fungicide product and mode of application on postharvest residue levels when managing sweet potato black rot caused by *Ceratocystis fimbriata*. **Hunter Collins** and Lina Quesada-Ocampo; North Carolina State University, Raleigh, NC.
- 10:30 – 10:45 AM *Candidatus Liberibacter asiaticus* and Asian citrus psyllid monitoring in commercial citrus groves in Georgia. **Carlton Collins**, Jonathan E. Oliver, Apurba Barman Alejandra M. Gabriel Munoz and Jimenez Madrid, and University of Georgia, Tifton.
- 10:45 – 11:00 AM Negative regulation of the HiVir gene cluster by *luxR* in *Pantoea ananatis* drives pathogenicity in onion center rot. **Anuj Lamichhane**¹, Brian Kvitko², and Bhabesh Dutta¹; ¹University of Georgia, Tifton, ²University of Georgia, Athens.
- 11:00 – 11:15 AM Developing a recombinase polymerase amplification (RPA) assay for detection of *Phytophthora capsici* in on-farm surface water sources. **Sarah Cochran-Murray**¹, Lina Quesada-Ocampo¹, and Timothy Miles²; ¹North Carolina State University, Raleigh, NC, ²Michigan State University, East Lansing, MI.
- 11:15 – 11:30 AM Oxathiapiprolin fungicide resistance mutation biosurveillance in *Pseudoperonospora cubensis* using spore trapping in North Carolina. **Mariana Prieto Torres** and Lina Quesada-Ocampo; North Carolina State University, Raleigh, NC.
- 11:30 – 11:45 AM Assessing the impact of exposure to field conditions on the effectiveness of oxytetracycline to control citrus pathogens. **Lauren Fessler Mathews**, Ana Redondo, Sanju Kunwar, Ozgur Batman; Southwest Florida Research and Education Center, University of Florida, Immokalee, FL.
- 11:45- 12:00 AM Genome sequencing, de novo assembly, and annotation of *Trichoderma longibrachiatum* isolate GEV 3550 collected from Florida agricultural soils. **Andrea K. Suazo Tejada**¹, Pei-Ling Yu², Katherine E. Smith², Jose Huguet-Tapia², Joseph Carrillo², Jeremy T. Brawner², and Gary Vallad¹; ¹Gulf Coast Research and Education Center, University of Florida, Wimauma, FL; ²University of Florida, Gainesville, FL.
- 12:00 – 2:00 PM LUNCH BREAK and POSTER VIEWING**
Boxed lunch provided for all registered attendees (Century Prefunction Area)
Posters displayed in Century Ballrooms B & C
- 12:00 – 2:00 PM Careers 101 Workshop: Strategic Conversation (Workshop)**
Leader: Nicole Gauthier, University of Kentucky
Location: Century Ballroom A
Sponsored by Corteva Agriscience.

Graduate Student Research Competition (Session III), Moderators: Andrea Suazo Tejada and Karamjit Kaur Baryah, SD-APS Graduate Students

- 2:00 – 2:15 PM Spatiotemporal spread of pollen-borne viruses and a viroid in South Carolina peach orchards. **Daniela Negrete-Moreno**, Garner Powell, Brodie Cox, and Elizabeth Cieniewicz; Clemson University, Clemson, SC
- 2:15 – 2:30 PM Mechanisms underlying XA21-mediated semi-sterility in rice. **Beatriz de Toledo Franceschi**, Satyam Vergish, and Wen-Yuan Song; University of Florida, Gainesville, FL.

Graduate Student Research Competition from Caribbean Division

- 2:30 – 2:45 PM From Flush to Fruit: Understanding the role of *Zasmidium citri-griseum* in the greasy green disorder. **Eva L. Mulandesa**¹, Mark Ritenour², Daniela Cardena², Edinson Diaz², Liliana Cano², and Megan Dewdney¹; ¹Citrus Research and Education Center, University of Florida, Lake Alfred, FL, ²Indian River Research and Education Center, University of Florida, Fort Pierce, FL.
- 2:45 – 3:00 PM A GIRAF (global invasion risk assessment framework) for plant pathogens! **Aaron Isai- Plex Sulá**, Romaric A. Mouafo-Tchinda, Berea A. Etherton, Ashish Adhikari, Jacobo R. Buritic, and Karen Garrett; Global Food Systems Institute/Emerging Pathogens Institute, University of Florida, Gainesville, FL,
- 3:00 – 3:15 PM Streamlined qPCR detection assay and nucleic acid extraction protocols for leaf scald and ratoon stunt disease in Louisiana sugarcane. **Joao V. P. Morales**, Annabel Miller, Mary B. Rollins, Madison T. Flasco, and Andre B. Gama; Louisiana State University, Baton Rouge, LA.
- 3:15– 3:30 PM Dynamics of ascospore dispersal of *Zasmidium citri-griseum* in citrus under protective systems. **Zahra Torkaman**, Megan Dewdney, and Lauren Diepenbrock; Citrus Research and Education Center, University of Florida, Lake Alfred, FL.
- 3:30 – 3:45 PM BREAK: Networking**
Location: Century Ballrooms B & C

Graduate Student Research Competition (Session IV), Moderators: Fabiano Perina and Claire Cooks, SD-APS Graduate Students

- 3.45 – 4:00 PM Occurrence of fungal plant pathogens in sweetpotato production in Uganda, Africa. **Carlos Morales**¹, Bonny Oloka¹, Bernard Yada², Craig Yencho¹, Michael Bradshaw¹, Peter Ojiambo¹, and Lina Quesada-Ocampo¹; ¹North Carolina State University, Raleigh, NC, ²National Crops Resources Research Institute, Uganda.

- 4:00 – 4:15 PM Evaluating the efficacy of succinate dehydrogenase inhibitor (SDHI) fungicides for managing pecan leaf dieback (PLDB) caused by *Neofusicoccum caryigenum*. **Richard Loomer**, Erin Arthur and Young-Ki Jo; Texas A&M University, College Station, TX.
- 4:15 – 4:30 PM Modeling policy interventions to contain Fusarium wilt of bananas in Colombia: Integrating Trade, Stakeholder Movement, and Environmental Factors. **Jacobo R. Buritica**¹, Karen Garrett¹, and Monica Betancourt²; ¹Global Food Systems Institute/Emerging Pathogens Institute, University of Florida, Gainesville, FL, ²AGROSAVIA Sede Central, Bogota, Columbia.
- 4:30 – 4:45 PM Fungicide evaluations for pecan leaf dieback in Texas and Georgia. **Erin Arthur**¹, Timothy B. Brenneman², Paul Goetze¹, Monte Nesbitt¹, and Young-Ki Jo¹; ¹Texas A&M University, College Station, TX, ²University of Georgia, Tifton.
- 4:45 – 5:00 PM A survey of fungal communities harbored in wild and agroforestry leaves of Criollo cacao during the dry season in Belize. **Greetja Nestler**¹, Lenardo Ash¹, Michelle Odoi², Holly Brabazon¹, Amber Gunter¹, Laura Whaley¹, Sarah Boggess¹, Bonnie Ownley¹, Kevin Moulton¹, Jacob Marlin³, DeWayne Shoemaker¹ and Denita Hadziabdic¹; ¹University of Tennessee, Knoxville, TN, ²Oregon State University, Corvallis, OR, ³Belize Foundation for Research and Environmental Education.
- 5:00-5:15 PM Pathogenicity of two *Colletotrichum* species at five floral developmental stages and efficacy of fungicides for citrus postbloom fruit drop (PFD) control. Mauricio Serrano and **Rebeca Vega-Alvarado**; University of Costa Rica, San José, Costa Rica.
- 5:15 – 6.00 PM** **BREAK: Poster Viewing** - *Presenters should be near their posters*
Location: Century Ballrooms B & C
- 6:00 – 8.00 PM** **Welcome Reception & Poster Viewing**
Location: Century Ballrooms B & C

Tuesday, March 11, 2025

Oral Technical Session I, Moderators: Renzo Ramirez and Toi Khetahouli, SD-APS Graduate Student

- 8:15-8.30 AM Natural language processing analysis as tool for disease risk priority management. **Laura Valbuena-Gaona**¹, Joaquin Ramirez-Gil¹, Karen Garrett², Jacobo Robledo Buritica²; ¹Universidad Nacional de Colombia, Bogota, Colombia, ²Global Food Systems Institute/Emerging Pathogens Institute University of Florida, Gainesville, FL.
- 8:30-8.45 AM Temperature optima of three *Rhizopus* species and pathogenicity to commercial peanut seeds at five temperatures. **Lucinda G. McEachin**, Timothy B. Brenneman, and Md. Aktaruzzaman; University of Georgia, Tifton.
- 8.45-9.00 AM Evaluating fungicide selection and application timings for control of 'yellow tuft' disease on zoysia grass. **Sharandeep S. Chahal** and Wendell J. Hutchens; University of Arkansas, Fayetteville, AR.
- 9.00-9.15 AM Is enigmatic cotton leafroll dwarf virus a threat to the cotton crop in Georgia, USA. **Surendra R. Edula**, Sudeep Bag, Lavesta C. Hand, Peng W. Chee, Robert C. Kemerait, John L. Snider, and Philip M. Roberts; University of Georgia, Tifton.
- 9.15-9.30 AM Adapting plant pathology to microgravity research: inoculation and growth of *Golovinomyces cichoracearum* on *Arabidopsis thaliana* using spaceflight hardware. **Kylee Soltez**¹, Chad V. Bosch², David Reed², and Andrew Schuerger¹; ¹Space Life Sciences Lab, University of Florida, Merritt Island, FL, ²Redwire Space Technologies Raleigh, NC.
- 9.30-9.45 AM Molecular insights of N, NSm, and NSs-gene of Orthotospovirus tomatomaculae indicating a purifying selection in cultivated hosts in the southeastern United States. **Bhavya Shukla**, Albert K. Culbreath, J. Michael Moore, Theodore McAvoy, Nino Brown, and Sudeep Bag; ¹University of Georgia, Tifton.
- 9.45-10.00 AM Understanding the effects of fumigant chemistry and application history on *Agroathelia rolfsii* sclerotia and tomato soil microecology. **Roshni H. Panwala**¹, Brittney Monus¹, Sarah L. Strauss¹, Nathan S. Boyd¹, Samuel Martins², and Gary Vallad¹; ¹Gulf Coast Research and Education Center, University of Florida, Wimauma, FL, ²University of Florida, Gainesville, FL.
- 10.00 – 10:15 AM** **BREAK: Networking**
Location: Century Ballrooms B & C

Oral Technical Session II, Moderators: Sean Wang and Amanda Mcvay, SD-APS Graduate Students

- 10:15–10:30 AM Exploring the potential of calcium propionate to manage fungal plant pathogens. **Harleen Kaur** and Guido Schnabel; Clemson University, Clemson, SC.
- 10:30 – 10:45 AM Beyond the negative: Potential of soil salinity to combat bacterial spot disease and enhance tomato flavor. **Ketsira Pierre**, Bruce Schaffer, Jeffrey B. Jones, Geoffrey Meru, and Shouan Zhang; ¹University of Florida, Gainesville, FL.
- 10:45 – 11:00 AM Disease progress of pecan bacterial leaf scorch in a commercial pecan orchard following summer hedging. **Timothy B. Brenneman**¹, Clive Bock², Rajendra Acharya¹, and Apurba Barman¹; ¹University of Georgia, Tifton, ²USDA-ARS, Fort Pierce, FL.
- 11.00 – 11:15 AM Exploring environmental factors influencing sweetpotato sour rot caused by *Geotrichum candidum*. **Kelly Avila** and Lina Quesada-Ocampo; North Carolina State University, Raleigh, NC.
- 11.15 – 11:30 AM Isolation of *Xanthomonas citri* pv. *malvacearum* bacteriophage "Malice" and its ability to reduce pathogen load in cotton seed. **Izabela Moura Duin**¹, Andrew Ernst¹, Evan Braswell², and Jennie Fagen¹; ¹North Carolina State University, Raleigh, NC, USDA APHIS PPQ S&T Insect Management and Molecular Diagnostics Laboratory, Edinburg, TX.
- 11.30-11.45 AM Encoding synthase for osmoregulated periplasmic glucans in *Xanthomonas euvesicatoria*: A critical player in bacteriocin susceptibility and fitness during plant infection. **Sophia T. McDuffee**¹, Lauren Jaworski¹, Jeannie Klein-Gordon², Gerald Minsavage¹, Erica Goss¹, Anuj Sharma¹, and Jeffrey B. Jones¹; ¹University of Florida, Gainesville, FL, ²USDA-ARS, Peoria, IL.
- 11.45-12.00 PM Effects of weather and disease on cotton seedling emergence. **Elias Zuchelli**¹, Heather Kelly¹, Maira Duffeck²; Tom W. Allen³, Tessie Wilkerson³, Robert Kemerait⁴, Kathy Lawrence⁵, Amanda Strayer-Scherer⁵, Terry A. Wheeler⁶, Paul P. Price⁷, Jason Woodward⁸, Terry Spurlock⁹, Ian Small¹⁰, Chase Floyd¹¹, Mandy Bish¹¹, Lucas Ughini Marques¹, Daisy Ahumada¹², Kayla Reid¹, and Madison L. Woodward¹; ¹University of Tennessee, Jackson, TN, ²Oklahoma State University, Stillwater, OK, ³Delta Research and Education Center, Mississippi State, University, Stoneville, MS, ⁴University of Georgia, Tifton, GA, ⁵Auburn University, Auburn, AL, ⁶Texas A&M University, Lubbock, TX, ⁷Macon Ridge Research Station, Louisiana State University, Winnsboro, LA, ⁸PhytoGen, ⁹University of Arkansas, Fayetteville, AR, ¹⁰North Florida Research and Education Center, University of Florida, Quincy, FL, ¹¹University of Missouri, Columbia, MO, ¹²North Carolina State University, Raleigh, NC.

12:00 – 2:00 PM **LUNCH BREAK: Networking & Poster Viewing**
Boxed lunch provided for all registered attendees (Century Prefunction Area)
Posters displayed in Century Ballrooms B & C

Oral Technical Session III, Moderators: *Eva Mulandesa and Mariana Corzo, SD-APS Graduate Students*

2:00 – 2:15 PM Analysis of TAL effector-mediated susceptibility in soybean. **Kyra Hertz**, Jose Huguet-Tapia, Mukesh Jain, and Frank F. White; University of Florida, Gainesville, FL.

2:15 – 2:30 PM Genetic analysis of *Clavibacter nebraskensis*, the agent of leaf blight of maize. **Mary Tamer**, Jose Huguet-Tapia, Mukesh Jain, and Frank F. White; University of Florida, Gainesville, FL.

2:30 – 2:45 PM Fungicide resistance in Texas isolates of *Stagonosporopsis* species, causal agents of gummy stem blight of watermelon. **Maxwell Sturdivant**, Madeleine Renard, Annette Saucedo Padron, Jillian Hamilton, Emily Hesidence, Olufemi Alabi, and Thomas Isakeit; Texas A&M University, College Station, TX.

2:45 – 3:00 PM Unraveling blueberry leaf rust: Pathogen diversity and resistance screening in UF Southern Highbush Blueberry genotypes. **Christ Mane Belizaire**¹, Romina Gazis¹, Patricio Munoz², Erica M. Goss², and Philip F. Harmon²; ¹Tropical Research and Education Center, University of Florida, Homestead, FL, ²University of Florida, Gainesville, FL.

3:00 – 3:15 PM Characterization of plant growth-promoting rhizobacteria for growth promotion and disease suppression in peanuts and turfgrass. **Kayla Sullins**, Amanda Strayer-Scherer, David Held; Auburn University, Auburn, AL.

3:15– 3:30 PM Field trials and disease scouting for areolate mildew in Tennessee cotton. **Allyson Sisco**, Elias Zuchelli, and Heather Kelly; University of Tennessee, Jackson, TN.

3:30 – 3:45 PM **BREAK: Networking**
Location: Century Ballrooms B & C

Oral Technical Session IV, Moderators: *Marie-Gabrielle Ayika, SD-APS Graduate Student, and Roshni Panwala, SD-APS Graduate Student Representative*

3:45 – 4:00 PM Assessment of biopesticide efficacy for year-round control of *Xanthomonas arboricola* pv. *pruni* on peach. **Junaed Ahmed** and Hehe Wang; Clemson University, Clemson, SC.

4:00 – 4:15 PM Investigations of media, photoperiod, and storage methodologies on *Ramulariopsis pseudoglycines*. **Kayla Reid**, Allyson Sisco, Elias Zuchelli,

and Heather Kelly; University of Tennessee, Jackson, TN.

- 4:15 – 4:30 PM Evaluation of *Macrophomina phaseolina* within a soybean production system and cover crop implementations. **Amanda Blazek**¹, Shelly Kerns², Alemu Mengistu³, and Heather Kelly¹; ¹University of Tennessee, Jackson, TN, ²Macon Ridge Research Station, Louisiana State University, Winnsboro, LA, ³USDA-ARS, Jackson, TN.
- 4:30 – 4:45 PM Impact of ear rots and foliar diseases on corn yield and fumonisin production across hybrids, fungicide treatment, and planting date. **Claire Cooke**¹, Autumn McLaughlin, and Heather Kelly¹; ¹University of Tennessee, Jackson, TN, ²Corteva Agriscience, Proctor, AR.
- 4:45 – 5:00 PM Tracing the hidden pathways: Alternative hosts and seed transmission of whitefly-transmitted viruses in cucurbits. **Dalvir K. Dhadly**¹, Saritha R. Kavalappara¹, Theodore McAvoy¹, Paul Severns², Alvin M. Simmons³ Rajagopalbabu Srinivasan⁴, and Sudeep Bag¹; ¹University of Georgia, Tifton, ²University of Georgia, Athens, ³Vegetable Laboratory, USDA, Charleston, SC, ⁴University of Georgia, Griffin.
- 5:00 – 6:00 PM** **BREAK: Poster Viewing**
Posters displayed in Century Ballrooms B & C
- 6:00 – 7.30 PM** **BREAK: Networking Event**
Graduate Student and Post-doc business meeting and networking event
Location: OFFSITE - Fifield Hall

Wednesday 12, 2025

- 8:00 – 10:00 AM** ***Symposium: Breaching Cultural and Global Barriers to Elevate Plant Health***, Moderators: Gary Vallad, SD-APS President and Cecilia Hernández Zepeda, CD-APS President
- 8.05 AM Sharing collaborative experiences in transcriptome analysis of plant-microbe interactions. **Liliana Cano**; Indian River Research and Education Center, University of Florida, Fort Pierce, FL.
- 8.30 AM “We need you here in Georgia.” Why international efforts matter? **Robert Kemerait**; University of Georgia, Tifton, GA.
- 9:00 AM Global communities collaborating to address global risk. **Karen Garrett**; Plant Pathology Department/Global Food Systems Institute/Emerging Pathogens Institute, University of Florida, Gainesville, FL.
- 9.30 AM My transatlantic journey: Advancing Science through resilience and diversity. **Bochra Bahri**; University of Georgia, Griffin, GA.
- 10.00 – 10:15 AM** **BREAK: Networking**
Posters displayed in Century Ballrooms B & C

10:15 – 11:30 AM

Symposium: Industry Sponsors

Moderators: Gary Vallad, SD-APS President

Andy Shirley, *Field Scientist, Corteva Agriscience, Cairo, GA*

Marty Wiglesworth, *Agronomy Services Manager, South & East Coast Commercial Unit, Syngenta Crop Protection, Greensboro, NC*

Kenny Seebold, *Senior Director, Field Research and Development, Valent U.S.A., LLC, Lexington, KY*

Joseph Mitchell, *Technical Service Representative, BASF Corp., Bonita Springs, FL*

Vijay Choppakatla, *Director of Research and Development, Biosafe Systems, LLC, East Harford, CT*

Traven Bentley, *Pathologist, Sakata Seed America, Inc., Fort Myers, FL*

Shine Taylor, *Southeast Field Development Representative, Gowan USA, Tampa, FL*

Eric Tedford, *Field Research and Development Manager, Summit Agro USA, Durham, NC*

11:30 – 2:00 PM

LUNCH BREAK AND BUSINESS MEETING:

Southern and Caribbean Divisions: *Century Ballroom A*

Boxed lunch provided for all registered attendees (Century Prefunction Area)

ALL POSTERS MUST BE REMOVED BY 1 PM.

Oral Technical Session V, *Moderators: Navdeep Kaur, SD-APS Graduate Student, and Elias Zuchelli, SD-APS Graduate Student Representative*

2:00 – 2:15 PM

CRISPR/Cas9-mediated editing of bs6 and bs8 homologs in tomato.

Mousami Poudel¹, Apekshya Parajuli¹, Gerald Minsavage¹, Samuel F. Hutton², Jeffrey B. Jones¹, and Anuj Sharma¹; ¹University of Florida, Gainesville, FL, ²Gulf Coast Research and Education Center, University of Florida, Wimauma, FL.

2:15 – 2:30 PM

Enhancing regional biosecurity: A rapid, field-ready RPA assay for citrus canker. **Raquel S. Hill**¹, Megan Dewdney², Liliana Cano³, and Carrie Lapaire Harmon¹; ¹University of Florida, Gainesville, FL, ²Citrus Research and Education Center, University of Florida, Lake Alfred, FL, ³Indian River Research and Education Center, University of Florida, Fort Pierce, FL.

2:30 – 2:45 PM

Limitations of Lateral Flow Immunostrips™ in detecting sugarcane mosaic virus in turfgrass: A Florida case study. **Alec J. Dunker**, Philip F. Harmon, and Carrie Lapaire Harmon; University of Florida, Gainesville, FL.

2:45 – 3:00 PM

Characterization and isolation of populations of *Ramularia* species in Alabama cotton. **Karamjit K. Baryah**, Zachary Noel, and Amanda Strayer-Scherer; Auburn University, Auburn, AL.

3:00 – 3:15 PM

Machine learning analysis of hyperspectral images for plant pathology.

Clayton P. Blake¹, Imana Power¹, Madison T. Flasco¹, and Arthur

Villordon²; ¹Louisiana State University Agricultural Center, Baton Rouge, LA, ²Sweet Potato Research Station, Louisiana State University Agricultural Center, Chase, LA.

3:15– 3:30 PM Validation of a TaqMan real-time polymerase chain reaction assay for rapid detection of *Fusarium oxysporum* f.sp. *lycopersici* in soil and water. **Jingya Yang**¹, Ningxiao Li², Frank Martin², Cassandra Swett, and Gary Vallad¹; ¹Gulf Coast Research and Education Center, University of Florida, Wimauma, FL, ²USDA-ARS, Salinas, CA, ³University of California, Davis, Davis, CA.

3:30 – 3:45 PM **BREAK**

Oral Technical Session VI, Moderators: Christ Mane Belizar, SD-APS Graduate Student

3:45 – 4:00 PM Comparative genomics and pathogenicity of *Pseudomonas alliivorans* strains from onions and cucurbits in the southeastern United States. **Michelle P. MacLellan**¹, Shatrupa Ray¹, Kiersten Fullem², Mathews Pare², Neha P. Potnis³, Carolee P. Bull⁴, Jeffrey B. Jones², and Bhabesh Dutta¹; ¹University of Georgia, Tifton, GA, ²University of Florida, Gainesville, FL, ³Auburn University, Auburn, AL, ⁴The Pennsylvania State University, University Park, PA.

4:00 – 4:15 PM Exploring local fungal microorganisms as biocontrol agents against *Cercospora apii* on Celery. **Larissa Carvalho Ferreira**¹ and Katia V. Xavier¹; ¹Everglades Research and Education Center, University of Florida, Belle Glade, FL.

4:15 – 4:30 PM *Diaphorina citri* flavi-like virus differentially modulates gene expression in Asian citrus psyllid, enhancing Liberibacter acquisition and transmission across its life stages. **Chun-Yi Lin**¹, Jacobo Robledo Buritica², Poulami Sarkar³, Ola Jassar⁴, Samara Vieira Rocha⁵, Ozgur Batuman⁶, Lukasz L. Stelinski¹, and Amit Levy¹; ¹Citrus Research and Education Center, University of Florida, Lake Alfred, FL, ²Global Food Systems Institute/Emerging Pathogens Institute, University of Florida, Gainesville, FL, ³University of California Riverside, Riverside, CA, ⁴Agricultural Research Organization, Volcani Center, Rishon LeZion, Isreal, ⁵Federal University of São Carlos, São Carlos, Brazil, ⁶Southwest Florida Research and Education Center, Immokalee, FL.

4:30 – 4:45 PM Emerging population shifts in Begomovirus coheni causing tomato yellow leaf curl disease in Southeastern US. **Manish Kumar**¹, Sudeep Bag¹, Theodore McAvoy¹, Ty Torrance¹, Cale Cloud¹, and Alvin M. Simmons²; ¹University of Georgia, Tifton, GA, ²USDA-ARS, Charleston, SC.

4:45 – 5:00 PM Evidence of multiple fungicide resistance in *Alternaria brassicicola* from naturally infested broccoli seeds. **Navjot Kaur**¹, Anoop Malik¹, Daniel Cerritos-Garcia², Sydney Everhart², and Bhabesh Dutta¹; ¹University of

Georgia, Tifton, GA, ²University of Connecticut, Storrs, CT.

5:00 – 5:15 PM Management of *Fusarium oxysporum*, *Rhizoctonia solani*, and *Agroathelia rolfsii* through Solarization in Kentucky High Tunnels. **April Lamb**¹, Annika Church, Edward Dixon, Misbah Munir², Kimberly Leonberger¹, Paula Luize Lessman¹, Henry S. Smith¹, Kathryn Pettigrew¹, Martin Polo¹, Jamari Taylor¹, Rachel Rudolph¹, and Nicole Gauthier¹; ¹University of Kentucky, Lexington, KY, ²Mississippi State University, Starkville, MS.

5:15 – 6:00 PM **BREAK**

6:00 – 9:00 PM **Networking Event: Southern and Caribbean Division Awards Banquet**
Dinner provided with meeting registration or guest ticket.
Location: Century Ballroom A.

Thursday, March 13, 2025

8:00 AM - 5:00 PM **Field Trip: Plant Science Research & Education Unit (PSREU) and Paynes Prairie - La'Chua Trail (*Pre-registration required*).**
Transportation through carpooling will be coordinated among tour participants. Tour participants must meet in the Hilton lobby by 7:45 AM. The tour will depart the hotel at 8:00 AM and will return to the Hilton by 5:00 PM. Lunch will be provided at the PSREU.

8:00 AM - 5:00 PM **NCAC14/SAC11 business meeting (*Pre-registration required*).**
Location: Hickory Room

10:00 AM – 3:00 PM **Emerging Viruses of Cucurbits Working Group**
Location: Azalea Room
Open session with online access (10 AM to noon), followed by closed meeting for EVCWG members. Additional details on the EVCWG website (<https://ecucurbitviruses.org/>).

See you next year in Georgia!

2025 SD-APS Meeting Planning Committee

Gary Vallad, SD-APS President
Bhabesh Dutta, SD-APS President-Elect
Rebecca A. Melanson, SD-APS Vice President and EVCWG Co-Chair
Katia Xavier, SD-APS Secretary-Treasurer
Roshni Panwala, SD-APS Graduate Student Representative
Elias Zuchelli, SD-APS Graduate Student Representative
Dan Anco, SD-APS Immediate Past President
Terry Spurlock, SD-APS Divisional Forum Representative
Gary Vallad, Local Arrangements

2025 CD-APS Meeting Planning Committee

Cecilia Hernández Zepeda, CD-APS President
Amit Levy, CD-APS Vice President
Megan M. Dewdney, CD-APS Secretary-Treasurer
Martha C. Giraldo Zapata, CD-APS Immediate Past President
Cecilia Monclova-Santana, CD-APS Divisional Forum Representative

Contributed Papers (Posters)

Posters will be displayed in Century Ballrooms B & C.

The maximum poster dimension is 40” x 40”. Posters must include their assigned number (once program is released) in the top left corner of their poster and can be displayed as early as Sunday afternoon (March 9), but must be removed promptly before 1 pm on Wednesday, March 12.

*Indicates student poster competition paper

1. *Investigating the impact of canker pathogens on vascular streak dieback-related symptom development in Redbud. **Pratima Subedi**, Cansu Oksel, Prabha, Terri Simmons, and Fulya Baysal-Gurel; Tennessee State University, Knoxville, TN.
2. *Evaluation of fungicides for the management of powdery mildew and Cercospora leaf spot in *Hydrangea macrophylla* under shade house conditions. **Christina Jennings**, Cansu Oksel, Sujan Dawadi, Terri Simmons, Fulya Baysal-Gurel; Tennessee State University, Knoxville, TN.
3. *Building SynComs with beneficial microbes from the peach phyllosphere to combat *Xanthomonas arboricola* pv. *pruni*. **Jordan Marshall** and Hehe Wang; Clemson University, Clemson, SC.
4. *Evaluating and validating a bacterial spot prediction model for *Xanthomonas arboricola* pv. *pruni* in field conditions. **Sherin Paul**, Daniel J. Anco, and Hehe Wang; Clemson University, Clemson, SC.
5. *Optimized protocols for the detection of sugarcane yellow leaf virus and quantification of physiological impacts due to virus-sugarcane interactions. **Annabel Miller**, Joao V. P. Morales, T. Flasco, Andre B. Gama, and Mary Beth Rollins; Louisiana State University, Baton Rouge, LA.
6. *Multi-locus sequence typing of a diverse collection of *Phytophthora palmivora* isolates and the newly described *Phytophthora heterospora* – Insights into global Distribution. **Alexander C. Fast**¹, Avril Rosano¹, Miaoying Tian², and Erica Goss¹; ¹University of Florida, Gainesville, FL, ²University of Georgia, Tifton.
7. *Identification of *Ralstonia pseudosolanacearum* phylotype I sequevar 14 infecting tomato and eggplant in North Carolina. **Prem B. Magar**¹, Alejandra Huerta¹, Gilles Cellier², Frank Louws¹, and Tika Adhikari¹; ¹NC State University, Raleigh, NC, ²ANSES, Plant Health Laboratory, France.
8. *Growth dynamics of *Xylella fastidiosa* almond strains in grapevine xylem sap. **Mamata K C**, and Leonardo De La Fuente, Auburn University, Auburn, AL.
9. Interactions between native soil microbiome and a synthetic microbial community reveals bacteria with persistent traits. **Jessica Velte**, Sameerika Mudiyansele, Olivia Hofmann, Samuel Martins, and Jose Huguet-Tapia; University of Florida, Gainesville, FL.
10. Global host-pathogen infection networks in major terrestrial agroecosystems. **Aaron Isai Plex Sulá**, Romaric Armel Mouafo-Tchinda, Ashish Adhikari, Jacobo Robledo Buritica, and

Karen Garrett; Global Food Systems Institute/Emerging Pathogens Institute, University of Florida, Gainesville, FL.

11. Endophytic fungal communities from agroforestry and wild leaves of Criollo cacao (*Theobroma cacao* L.) in Southern Belize at the end of the wet season. **Lenardo Ash**¹, Greetja Nestler¹, Michelle Odoi², Holly Brabazon¹, Amber Gunter¹, Laura Whaley¹, Sarah Boggess¹, Bonnie Ownley¹, Kevin Moulton¹, Jacob Marlin³, DeWayne Shoemaker¹, and Denita Hadziabdic¹; ¹University of Tennessee, Knoxville, TN, ²Michigan State University, East Lansing, MI, ³Belize Foundation for Research and Environmental Education, Belize.
12. First report of *Fusarium oxysporum* f. sp. *apii* race 2 infecting celery (*Apium graveolens*) in Florida. **Ludmila L. Silva**¹, Tarciso A. Ferreira Junior², Larissa Carvalho Ferreira¹, and Katia V. Xavier¹; ¹Everglades Research and Education Center, University of Florida, Belle Glade, FL, ²Universidade Federal de Viçosa, Viçosa, MG, Brazil.
13. Identification of *Phytophthium* sp. as the causal agent of root rot in Methley plum (*Prunus salicina* Lindl. ‘Methley’) and Japanese holly (*Ilex crenata* Thunb.). **Cansu Oksel**¹, Farhat Avin², Prabha Liyanapathirana³, Terri Simmons¹, Batu Arik⁴, and Fulya Baysal-Gurel; ¹Tennessee State University, Nashville, TN, ²Bayer, McMinnville, ³Tennessee Department of Agriculture, Nashville, TN, ⁴University of Tennessee, Knoxville, TN.
14. How viral, fungal, and bacterial diseases on tanager (*Xanthosoma* spp.) limits its production in Puerto Rico. Wanda Almodovar and **Martha C. Giraldo**; University of Puerto Rico, Mayagüez, PR.
15. Unraveling the genetic diversity of *Epichloë* endophytes in tall fescue and ryegrass and their toxicity profiles in Alabama. **Precious E. Chukwubem**¹, Anthony Adesemoye²; ¹Auburn University, Auburn, AL, ²Soil Dynamics Research, USDA-ARS, Auburn, AL.
16. Isolation and characterization of the broad host range *Ralstonia solanacearum* phage “Rally”; with an emphasis on biocontrol potential. **Izabela Moura Duin**¹, Andrew Ernst¹, Evan Braswell², and Jennie Fagen¹; ¹North Carolina State University, Raleigh, NC, USDA APHIS PPQ S&T Insect Management and Molecular Diagnostics Laboratory, Edinburg, TX.
17. Molecular characterization and management of *Colletotrichum* spp. causing anthracnose in Florida cucurbit production. **Amanda McVay**¹, Gary Vallad², Pamela Roberts¹, and Bhabesh Dutta³; ¹Southwestern Florida Research and Education Center, University of Florida, Immokalee, FL, ²Gulf Coast Research and Education Center, University of Florida, Wimauma, FL, ³University of Georgia, Tifton, GA.
18. *Xanthomonas citri* pv. *lagerstroemium* isolated from crape myrtle foliar leaf spot, causes citrus canker-like symptoms on key lime. Izabela Moura Duin¹, David Ritchie¹, Evan Braswell², and **Jennie Fagen**¹; ¹North Carolina State University, Raleigh, NC, USDA APHIS PPQ S&T Insect Management and Molecular Diagnostics Laboratory, Edinburg, TX.
19. Exploring the role of plant growth-promoting rhizobacteria in mitigating virus infections: Towards sustainable agriculture. **Bibechana Paudel** and Sung-Hwan Kang; Auburn University, Auburn, AL.

20. Evaluating transcriptome profiles of scab susceptible and resistant pecan trees. **Jordan Brungardt**¹, Yanina Alarcon², Jason Shiller³, Carolyn Young⁴, Maria Monteros⁵, Jennifer Randall⁶, and Clive Bock⁷; USDA-ARS ¹Fruit and Tree Nut Research, USDA-ARS, Byron, GA, ²University of Texas Southwestern, Dallas, TX, ³The New Zealand Institute for Plant and Food Research, Auckland, NZ, ⁴North Carolina State University, Raleigh, NC, ⁵Bayer Crop Science, St. Louis, MO, New Mexico State University, Las Cruces, NM, ⁷U.S. Horticultural Research Laboratory, USDA-ARS, Fort Pierce, FL.
21. Disease pressures of Pierce's disease-resistant grapevine hybrids at a research farm in Upstate South Carolina. **Annie Bruno**, Juan Carlos Melgar, and Guido Schnabel; Clemson University, Clemson, SC.
22. Evaluating the prevalence of the virulent *Neopestalotiopsis* sp. on strawberry in the Southeastern United States. **Alejandra M. Jimenez Madrid** and Phillip Brannen; University of Georgia, Athens, GA.
23. Phenotypic characterization of *Bipolaris maydis* isolated from Northern Corn Leaf Blight lesions on maize. **Katia V. Xavier**¹, Vitor A. S. Moura¹, Larissa Carvalho Ferreira¹, and Marcio F. R. Resende² Everglades Research and Education Center, University of Florida, Belle Glade, FL, ²University of Florida, Gainesville, FL.
24. Are there edge effects for bacterial spot of peach? **Milan Panth**¹, Phillip Brannen², and Hehe Wang¹; ¹Clemson University, Clemson, SC, ²University of Georgia, Athens, GA.
25. Anaerobic soil disinfestation effect on fungi and heterotrophic bacteria in organic sweet potato production. **Meredith Tucker**, Julia Kerrigan, and R. Karthikeyan; Clemson University, Clemson, SC.
26. Role of fusaric acid in palm-*Fusarium* interaction. **Marie-Gabrielle Ayika**¹, Jeffrey Rollins, and Braham Dhillon¹; Fort Lauderdale Research and Education Center, University of Florida, Fort Lauderdale, FL, ²University of Florida, Gainesville, FL.
27. Assessing the risk of laurel wilt in avocado-producing and native host Regions of Latin America: An ecological niche modeling approach. Juan C. Garcia Peña¹, Andres Lira-Noriega², Laura A. Valbuena-Gaona³, and **Joaquin G. Ramirez-Gil**; ¹Ghent University, Ghent, Belgium, ²Instituto de Ecología, A.C., Xalapa, Veracruz, México, ³Universidad Nacional de Colombia, Bogota, Colombia.
28. Disaster plant pathology: Assessing injury profiles for food security crops across climate gradients in the Great Lakes region of Africa. **Romario A. Mouafo-Tchinda**¹, Aaron Isai Plex Sulá¹, Berea A. Etherton¹, Joshua S. Okonya², Gloria V. Nakato³, Yanru Xing¹, Jacobo Robledo Buritica¹, Ashish Adhikari¹, Guy Blomme⁴, Déo Kantungeko⁵, Anastase Nduwayezu⁶, Jan Kreuze⁷, Jürgen Kroschel⁸, James Legg⁹, and Karen Garrett¹; ¹Global Food Systems Institute/Emerging Pathogens Institute, University of Florida, Gainesville, FL, ²Association for Strengthening Agricultural Research in Eastern and Central Africa, Entebbe, Uganda, ³International Institute of Tropical Agriculture, Arusha, Tanzania, ⁴Bioversity International, Addis Ababa, Ethiopia, ⁵International Institute of Tropical Agriculture, Bujumbura, Burundi, ⁶Rwanda Agriculture Development and Animal Resources Board (RAB), Ruhengeri, Rwanda, ⁷International Potato Center (CIP), Lima, Peru, ⁸Hans-

Ruthenberg-Institute for Tropical Agricultural Sciences, University of Hohenheim, Stuttgart, Germany, ⁹International Institute of Tropical Agriculture, Dar es Salaam, Tanzania.

29. CitrusYield: A machine learning model to predict citrus yield and evaluate huanglongbing mitigation strategies. **Jacobo Robledo Buritica**¹, Amit Levy², Tripti Vashisth², and Karen Garrett¹; ¹Global Food Systems Institute/Emerging Pathogens Institute, University of Florida, Gainesville, FL, University of Florida, ²Citrus Research and Education Center, Lake Alfred, FL.
30. Developing a decision support system for management of bacterial spot of tomato: Characterizing inoculum sources, epidemic potential, and management scenarios. **Jacobo Robledo Buritica**¹, Gary Vallad², Ashish Adhikari¹, and Romaric A. Mouafo-Tchinda¹; ¹Global Food Systems Institute/Emerging Pathogens Institute, University of Florida, Gainesville, FL, ²Gulf Coast Research and Education Center, University of Florida, Wimauma, FL.
31. Risk assessment supporting mitigation of pathogens and pests: Perspectives on rice health in Nepal and the global emergence of false smut. **Ashish Adhikari**, Aaron Isai Plex Sulá, Romaric A. Mouafo-Tchinda, Jacobo Robledo Buritica, Berea A. Etherton, Katelin Alcock, Robert Fontan, Theodore J Stronkowsky, and Karen Garrett; Global Food Systems Institute/Emerging Pathogens Institute, University of Florida, Gainesville, FL
32. First steps towards biological control of aflatoxin in Guatemalan maize. **Mark Weaver**¹, Curt Bowen², Lilly Park¹, Samantha Drewry³, and Jennifer Mandel³; ¹Biological Control of Pests Research, USDA ARS, Stoneville, MS, ²Semilla Nueva, Boise, ID, ³University of Memphis, Memphis, TN.
33. Determining the efficacy and cost benefits of LIDAR (Smart Spray) systems for control of pecan scab (*Venturia effusa*) in commercial pecan orchards. Clint Herndon and **Timothy B. Brenneman**; University of Georgia, Tifton, GA.
34. Fungicide spray initiation by planting date on leaf spot disease of peanuts. **Alana G. Atkinson**¹, Albert K. Culbreath, Robert Kemerait, and Emily Cantonwine; ¹University of Georgia, Tifton, GA, ²Valdosta State University, Valdosta, GA.
35. Is flutriafol the new kid on the block for managing laurel wilt disease in avocado? Maria de los Angeles Lugo-Duque¹, **Monica Navia-Urrutia**², and Romina Gazis¹; ¹Tropical Research and Education Center, University of Florida, Homestead, FL, ²Everglades Research and Education Center, University of Florida, Belle Glade, FL.
36. Evaluation of fungicides and biofungicides for the management of *Botryosphaeria dothidea* canker in redbud. **Pratima Subedi**, Terri Simmons, Sujan Dawadi, and Fulya Baysal-Gurel; Tennessee State University, Knoxville, TN.
37. Fungicide efficacy and accompanying influence of post-application precipitation for management of southern stem rot of peanut and examination of active ingredient co-application with micronized sulfur. **Daniel J. Anco**¹, Justin Hiers¹, and Brendan Zurweller²; ¹Clemson University, Clemson, SC, Mississippi State University, ²Mississippi State, MS.

38. Evaluation of fungicides to control phytophthora root rot on dogwood (*Cornus florida*). **Cansu Oksel**, Terri Simmons, Sujan Dawadi, Christina Jennings, Pratima Subedi, and Fulya Baysal-Gurel; Tennessee State University, Knoxville, TN.
39. On-farm studies of fungicides for managing peanut diseases in North Florida. **Nicholas Dufault**¹ and Keith Wynn²; ¹University of Florida, Gainesville, FL, ²University of Florida, Jasper, FL.
40. A fungicide program case study designed for control of pecan scab populations in Texas orchards. **Paul Goetze**, Monte Nesbitt, and Young-Ki Jo; Texas A&M University, College Station, TX.
41. Cross-resistance between the biorational fungicide Howler EVO and the synthetic fungicide fludioxonil in *B. cinerea*. **Johanna Wesche**, Peishan Wu, James Faust, and Guido Schnabel; Clemson University, Clemson, SC.
42. Succinate dehydrogenase gene mutations confer fungicide resistance in *Venturia effusa*. **Saika Beerval**, Paul Goetze, and Young-Ki Jo; Texas A&M University, College Station, TX.
43. Fungicide resistance levels of *Clavireedia* spp. and efficacy of biofungicides on dollar spot of turfgrass in Georgia, USA. **Bohra A. Bahri**¹, Ghimire Bikash¹, Md. Aktaruzzaman², Harshita Saxena¹, Jonathan E. Oliver², James W. Buck¹, and Alfredo Martinez-Espinoza¹; ¹University of Georgia, Griffin, GA, ²University of Georgia, Tifton, GA.
44. Results from recent organic blueberry disease management field trials in Georgia (U.S.A.). **Jonathan E. Oliver**; University of Georgia, Tifton, GA.
45. Biofungicide use for the control of Phytophthium root rot in redbud (*Cercis canadensis*). **Christina Jennings**, Cansu Oksel, Sujan Dawadi, Terri Simmons, and Fulya Baysal-Gurel; Tennessee State University, Knoxville, TN.
46. Copper-tolerant and copper-sensitive *Xanthomonas campestris* isolated from two adjacent Florida cabbage fields. **Kiersten Fullem**, Mukesh Jain, Kristin Beckham, Frank F. White, and Nicholas Dufault; University of Florida, Gainesville, FL.
47. Efficacy of sanitizers in reducing plant-to-plant transfer of *Agrobacterium tumefaciens* using pruning shear. **Cansu Oksel**, Terri Simmons, Sujan Dawadi, and Fulya Baysal-Gurel; Tennessee State University, Knoxville, TN.
48. Novel therapies targeting *Candidatus Liberibacter asiaticus* in citrus phloem using antibiotics and single-chain antibodies. **Jorge E. Santiago Vazquez**¹, Zhongwu Guo², Robert Turgeon³, Nabil Killiny¹, and Amit Levy¹; ¹Citrus Research and Education Center, University of Florida, ²Department of Chemistry, University of Florida, Gainesville, FL, ³Cornell University, Ithaca, NY.
49. Elucidating the biochemical role of Alt proteins in thiosulfinate tolerance and virulence of *Pantoea ananatis*. **Simrandeep Kaur**, Vincent Starai, and Brian Kvitko; University of Georgia, Athens, GA.

50. Enhancing HLB management: Antibiotic rotations, combinations, and new therapeutics for Florida citrus. **Sanju Kunwar**¹, Lauren Fessler¹, Ana Redondo¹, Kellee Britt-Ugartemendia², and Ozgur Batuman¹; ¹Southwest Florida Research and Education Center, University of Florida, Immokalee, FL, ²MilliporeSigma, Rockville, MD.
51. The calcium-virulence connection: Conservation across *Xylella fastidiosa* strains. **Deekshya Adhikari**, Leonardo De La Fuente, and Deepak Shantharaj; Auburn University, Auburn, AL.
52. Identification of TALE DNA-binding domains using long-read sequencing. **Jose Huguet-Tapia**, Peiqi Zhang, Mukesh Jain, and Frank F. White; University of Florida, Gainesville, FL.
53. Invasion and spread of Asian citrus psyllids and HLB in Florida. **Susan E. Halbert**¹ and Nicholas Sizemore²; ¹Florida Department of Agriculture and Consumer Services, Gainesville, FL, ²Johns Hopkins University, Baltimore, MD.
54. Bamboo Mosaic Virus detected in Florida crops using universal primer. **Donielle Turner**, Chun-Yi Lin, Chunxia Wang, Michael Rogers, and Amit Levy; Citrus Research and Education Center, University of Florida, Lake Alfred, FL.
55. Quantifying seasonal virus dynamics of Prunus Necrotic Ringspot Virus and Prune Dwarf Virus. **Garner Powell**, Elise Schnabel, and Elizabeth Cieniewicz; Clemson University, Clemson, SC.
56. First virome outlook of the largest mango germplasm collection. **Alina S. Puig**¹, Oscar Hurtado-Gonzales², Xiaojun Hu², Gul Ali³, and Angie Burgos Bastidas⁴; ¹Foreign Disease/Weed Science Research USDA-ARS, Fort Detrick, MD, ²USDA-APHIS, Beltsville, MD, ³Subtropical Horticulture Research, USDA-ARS, Miami, FL, ⁴ORISE, Fort Detrick, MD.
57. Evaluation of atypical symptoms of Rose Rosette Disease. **Connor J. Cook**, Jake Ueckert, and Kevin Ong; Texas A&M University, College Station, TX.
58. Watermelon chlorotic stunt virus: A new threat to cucurbit production in the United States. **William M. Wintermantel**; Crop Improvement and Protection Research, USDA ARS, Salinas, CA.
59. The root of the problem: Hop Latent Viroid alters metabolism of *Cannabis sativa*. **Ansley Burtch**¹, Emily Lesinski², MengLing He¹, Scott Emrich³, and Kimberly Gwinn; ¹University of Tennessee, Knoxville, TN, ²Purdue University, West Lafayette, IN, ³Electrical Engineering and Computer Science, University of Tennessee, Knoxville, TN.
60. A comparison of viral concentration methods to detect Pepper mild mottle virus in water samples. Ramon Vega-Vázquez¹, **Cecilia Hernández-Zepeda**², Gabriela Rosiles-González², and Oscar Moreno-Valenzuela²; ¹Universidad Tecnológica de Cancun, Cancun, Mexico, ²The Yucatan Center for Scientific Research (Centro de Investigación Científica de Yucatán), Mérida, Mexico.

61. Unveiling major evolutionary events in betasatellite biodiversity associated with the cotton leaf curl disease complex in Pakistan, an unprecedented paradigm shift. Muhammad Javed Iqbal, Amir Raza, Dinusha Maheepala, and **Judith K. Brown**; University of Arizona, Tucson, AZ.
62. Dynamic genome variability associated with Cotton leaf curl disease geminiviruses in Pakistan. Amir Raza, Muhammad Javed Iqbal, and **Judith K. Brown**; University of Arizona, Tucson, AZ.
63. A recombination-aware Bayesian molecular clock analysis of cotton leafroll dwarf virus. Raphael O. Adegbola, Muhammad Javed Iqbal, Nathaniel D. Ponvert, Dinusha Maheepala, and **Judith K. Brown**; University of Arizona, Tucson, AZ.
64. Profiling latent disease of Hop Latent Viroid using Near-infrared spectroscopy. **Michael S. Koretsky**, Ethan Gregg, and Jeanmarie Verchot; Texas A&M University, College Station, TX.
65. The calcium-virulence connection: conservation across *Xylella fastidiosa* strains. **Deekshya Adhikari**, Leonardo De La Fuente, and Deepak Shantharaj; Auburn University, Auburn, AL.
66. An investigation into the host adaptability and survival capability of *Pseudomonas alliivorans* isolated from onions and cucurbits. **Shatrupa Ray**¹, Michelle P. MacLellan¹, Kiersten Bushong², Jeffrey Jones², and Bhabesh Dutta¹; ¹University of Georgia, Tifton, GA, ²University of Florida, Gainesville, FL.
67. Disease pressures of Pierce's disease-resistant grapevine hybrids at a research farm in Upstate South Carolina. **Annie Bruno**, Juan Carlos Melgar, and Guido Schnabel, Clemson University, Clemson, SC.
68. Regional and national strategies for laurel wilt management. **Romaric Armel Mouafo-Tchinda**¹, Aaron Isai- Plex Sulá¹, Berea A. Etherton¹, Robin Choudhury²; Romina Gazis³; Jonathan Crane³, Karen Garrett¹, ¹Plant Pathology Department/Global Food Systems Institute/Emerging Pathogens Institute, University of Florida, Gainesville, FL, ²University of Texas Rio Grande Valley, Edinburg, TX, ³Department of Plant Pathology, University of Florida, Tropical Research and Education Center, Homestead, FL.

2025 SPONSORS

The Southern & Caribbean Divisions appreciates the support of:



CORTEVATM
agriscience

syngenta[®]



SUMMIT AGRO[®]

Gowan[®]
USA



Bayer CropScience



BioSafe[®]
Systems[®]

HM • CLAUSE



BASF

We create chemistry

CERTIS
Biologicals

SAKATA[®]